

# R1730

## Remote Control Specification

### Type specification

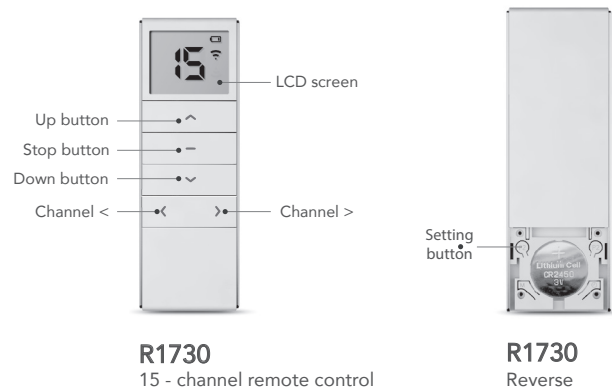

### Technical support

**CAUTION**  
RISK OF EXPLOSION IF BATTERY IS REPLACED BY AN INCORRECT TYPE.  
DISPOSE OF USED BATTERIES ACCORDING TO THE INSTRUCTIONS.

Notice: Do not expose the remote control to moisture or heat. When you use the remote control, if emission distance is short and less effective, please replace battery. Please recycle batteries.

#### Technical Specification

- Input voltage: 3V(cr2450)
- Transmitting frequency: 433MHz
- Transmitting power: 10 milliwatt
- Operating temperature: -10°C—50°C
- Transmission distance: 200 metres open office, 35 metres on two walls

## 1. Pairing the remote control with tubular motor and setting direction

During the settings, the time between the two operations must be less than 4 seconds, otherwise it will quit the setting.

**!** To programme the new remote control delete all data from the motor.

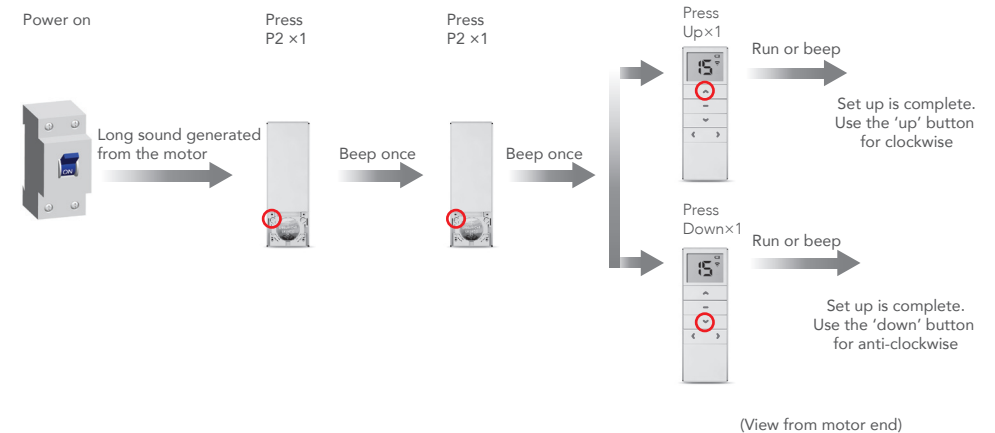

## 2. Setting number of channels

**!** In the setting state, press the up or down button quickly to quit. If you want to change the channels, reset unit.

Press and hold (Channel > button and channel < button) x1  
Hold down Channel > button and Channel < button  
Press Channel > button or Channel < button, to select the channel number (channel 1 to channel 15) you need.  
Press Stop x1

